

Product Data

Dimensions

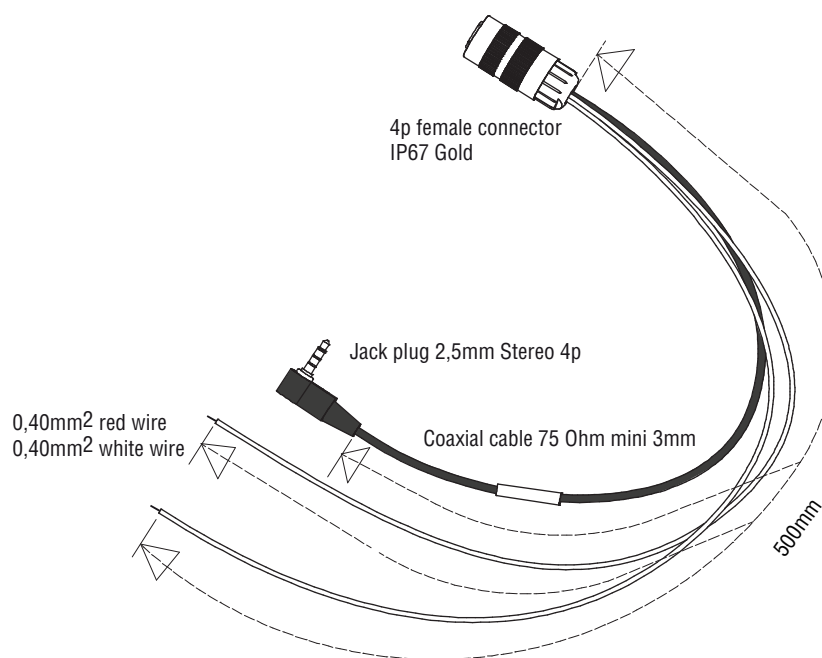
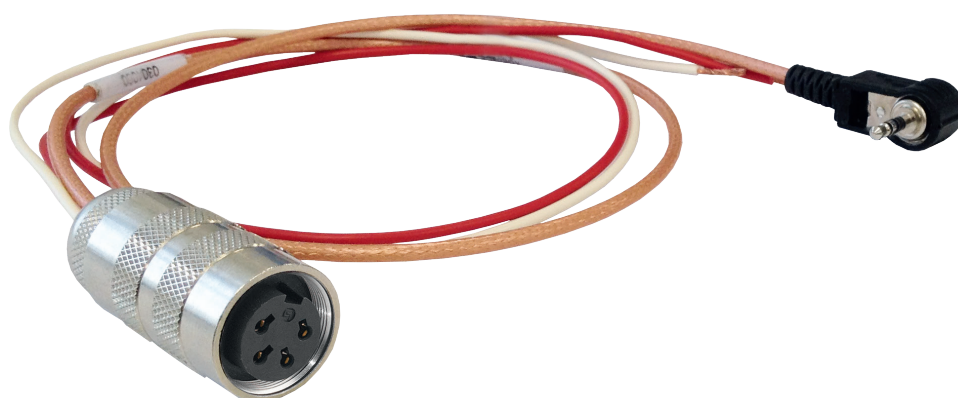

TECHNICAL DATA

Adapter Cable 0,5m 2,5mm Jack Plug b4F

Article number	Description 0308430
Application	Suitable for navigation systems to enable automatic switching to Rear View Camera when using reversing lights.
Operating temperature	-40°C to +85°C.
Protection	IP 67 according to IEC 60529.
Included	Coaxial cable 75 Ohm (RG179) mini 3 mm; 4 p. female connector, gold; Jack plug 2,5mm Stereo 4p.
Weight	0,05kg.

Application Suitable for use with SNOOPER models 5700, 5800, 6400, 6800, 8100.

Note If you want to add more than one camera please contact ORLACO or your local dealer. If you want to connect a rear view camera please use a mirror camera or set your system to Mirror mode.

Electrical connection

Connector 4p female

- 1 = Coax core (Video signal) Connected to pin 3 Jack plug
- 2 = Coax screen (Video GND) Connected to pin 4 Jack plug
- 3 = Red (12V/DC)
- 4 = White (0V)

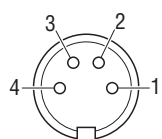

Solder side
Female connector

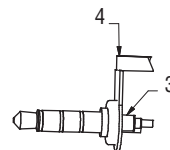

Side view
Jack plug

Utilisation of the cable in a system

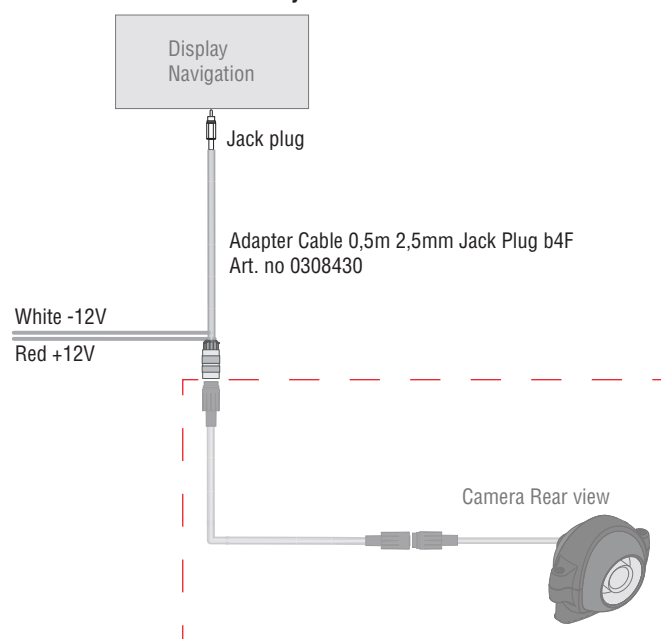

Extra cable and Camera Rear view must be ordered separately.

All data subject to change without notice. All dimensions are for commercial purpose only.
The camera/display systems from Orlaco comply with the latest CE, ADR, EMC and mirror-directive regulations, where applicable.
All products are manufactured in accordance with the ISO 9001 quality management system, ISO/TS 16949 quality automotive, ISO 14001 environmental management systems and all Ex products with the IECEx scheme and ATEX directives, where applicable.



D S 0 3 0 4 0 6 0 E N R 2 0